

# Spring Creek

## Affordable Duplex

### Downstairs

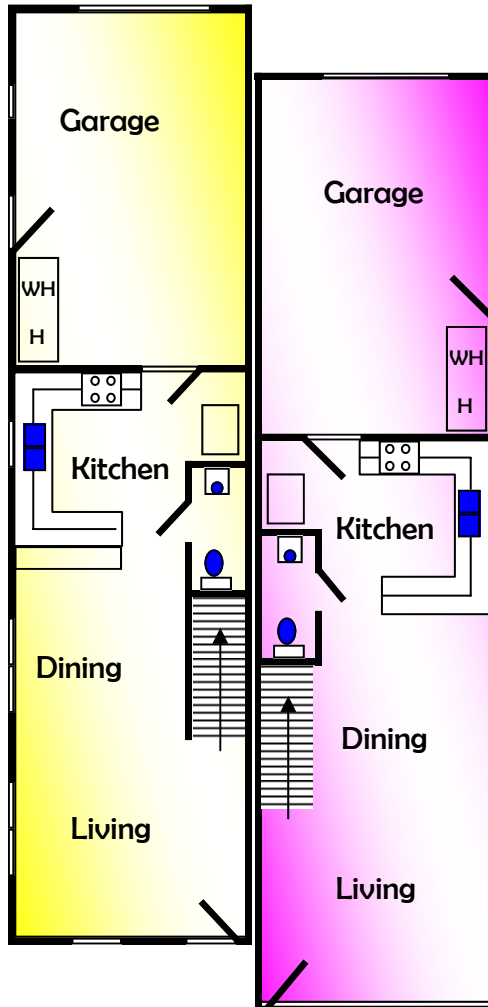

### Upstairs

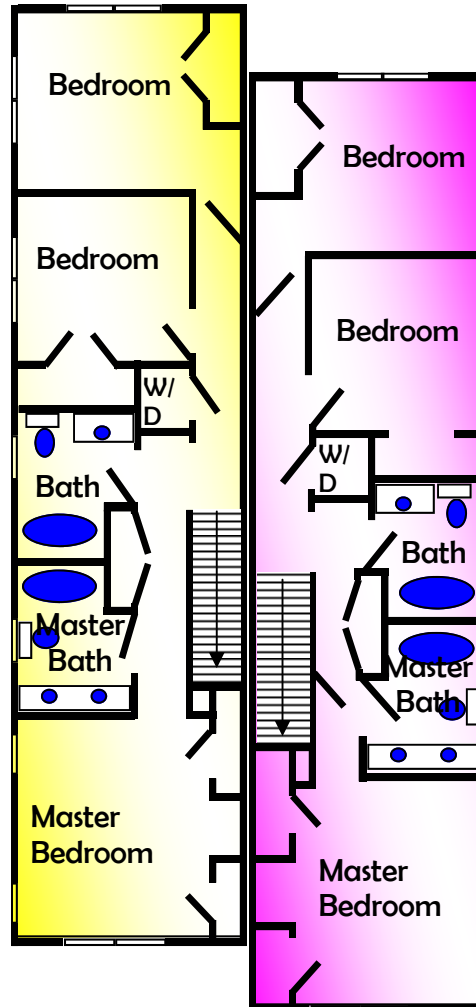

### ABOUT

These Duplex units are designed with value. Constructed with a dual party wall and designed where bathrooms and bedrooms are on outer part of the floor plan prevents neighbor noise. High ceilings and open windows.

### FEATURES

- 1,300 Square Feet
- 3 Bedrooms
- 2.5 Bathrooms
- 1 Car Garage Attached

### AFFORDABLE QUALIFICATIONS

- Max Income @120% Nevada County
- Tahoe / Truckee resident or worker
- Upto \$40k downpayment assistance available
- Qualifications & Restrictions apply

*Priced at \$305,000*

**TRUCKEE  
RIVER  
Associates**

For More Information Contact:

**Karl Saimre**

530.587.7633

[karl@truckeeriverassociates.com](mailto:karl@truckeeriverassociates.com)

[www.truckeeriverassociates.com](http://www.truckeeriverassociates.com)

The information contained herein is not guaranteed and has been secured from sources believed to be reliable. The agent makes no guarantees, warranties or representations as to the completeness or accuracy, therefore the presentation of this property is subject to errors, omissions and changes as deemed necessary during the development process. Equal housing opportunity.